

CUSTOMER PART No.

CUSTOMER

# CAN ART STD.

DIE No.

EH05521

DESCRIPTION

3/4" SCHEDULE 80 PIPE

PROPOSAL No.

H-5637

NOTE: BREAK ALL CORNERS WITH 0.015" (.38 MM) RADIUS UNLESS OTHERWISE NOTED. STANDARD TOLERANCES TO APPLY UNLESS OTHERWISE SPECIFIED.

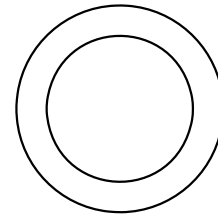
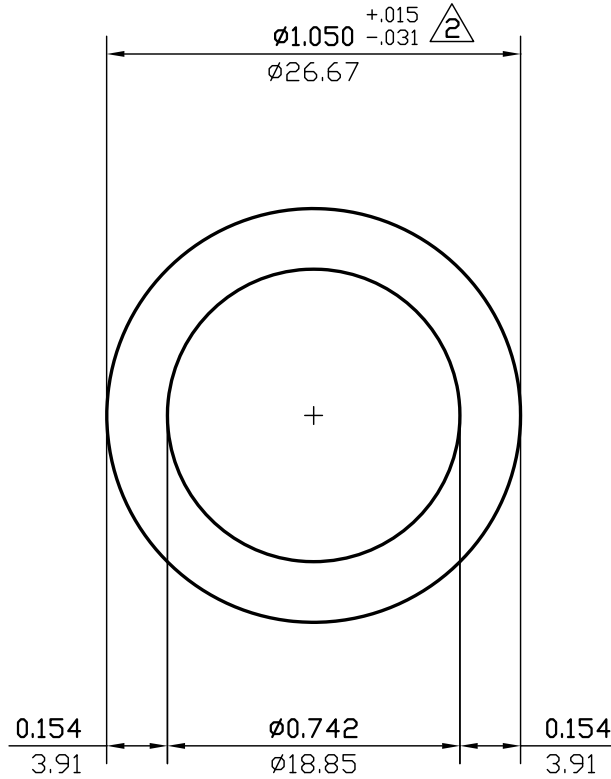

ACTUAL SIZE

WALL THICKNESS 0.154 (3.91) EXCEPT AS SHOWN

DATE	REV	DESCRIPTION	BY
03/10/23	3	REMOVED EXPOSED SURFACES AND ALLOY	JASON
07/14/15	2	ADDED +.015/-0.031 TOLERANCE.	P.M.
EST.AREA	0.433	IN. <sup>2</sup>	EST.AREA 280
			MM. <sup>2</sup>
EST.WT.	0.512	LBS/FT.	EST.WT. 0.761
			KG/M.
EST.PER.	5.630	IN.	EST.PER. 143.0
			MM.
OUT PER.	3.299	IN.	OUT PER. 83.8
			MM.
C.C.D.	1.050	IN.	C.C.D. 27
			MM.
FACTOR 11	FINISH M/F	ALLOY & TEMP.	
CKD BY	SCALE 2:1	DWN BY C.P.	DATE 06/20/96

## CAN ART

ALUMINUM EXTRUSION INC.

85 PARKSHORE DRIVE  
BRAMPTON, ONT L6T 5M1  
TEL. NO. (905) 791-1464  
FAX NO. (905) 791-9151  
E-MAIL: canart@canart.com

THIS DRAWING IS NOT NECESSARILY A COPY OF YOUR ORIGINAL. PLEASE APPROVE DIMENSIONS AND TOLERANCES INDICATED. CAN ART ASSUMES NO RESPONSIBILITY EITHER TECHNICAL OR LEGAL FOR HAVING THIS SHAPE MADE. THE CUSTOMER AGREES TO FULLY PROTECT CAN ART ALUMINUM FROM CLAIMS OF OTHERS RESULTING FROM THIS SHAPE.

SIGNED: \_\_\_\_\_ DATE: \_\_\_\_\_